

## Installation Information

### Item #P0156

### Handheld Shower Conversion Kit

Warranted only if installed by a qualified licensed plumber.

1. The diverter kit includes bushings and adapters to fit a  $\frac{3}{4}$ " IPS Male fitting on the faucet.
2. Attach the diverter to the faucet Male IPS fitting.
3. Remove the top  $\frac{3}{4}$ " nut and cone washer from the diverter. Slip the nut onto the bottom end of the  $\frac{5}{8}$ " OD riser and then push the cone washer up onto the riser leaving  $\frac{1}{4}$ " of the bottom of the riser exposed. The tapered end of the cone washer points down.
4. Holding the riser in a vertical position, tighten the nut onto the diverter compressing the cone washer.
5. Attach the c-clamp of the handheld cradle to the riser at your desired height.
6. Attach the nut end of the hose to the vacuum breaker that is installed on the outlet of the diverter.
7. Attach the tapered end of the hose to the handheld shower handle. Rest the handheld on the cradle.

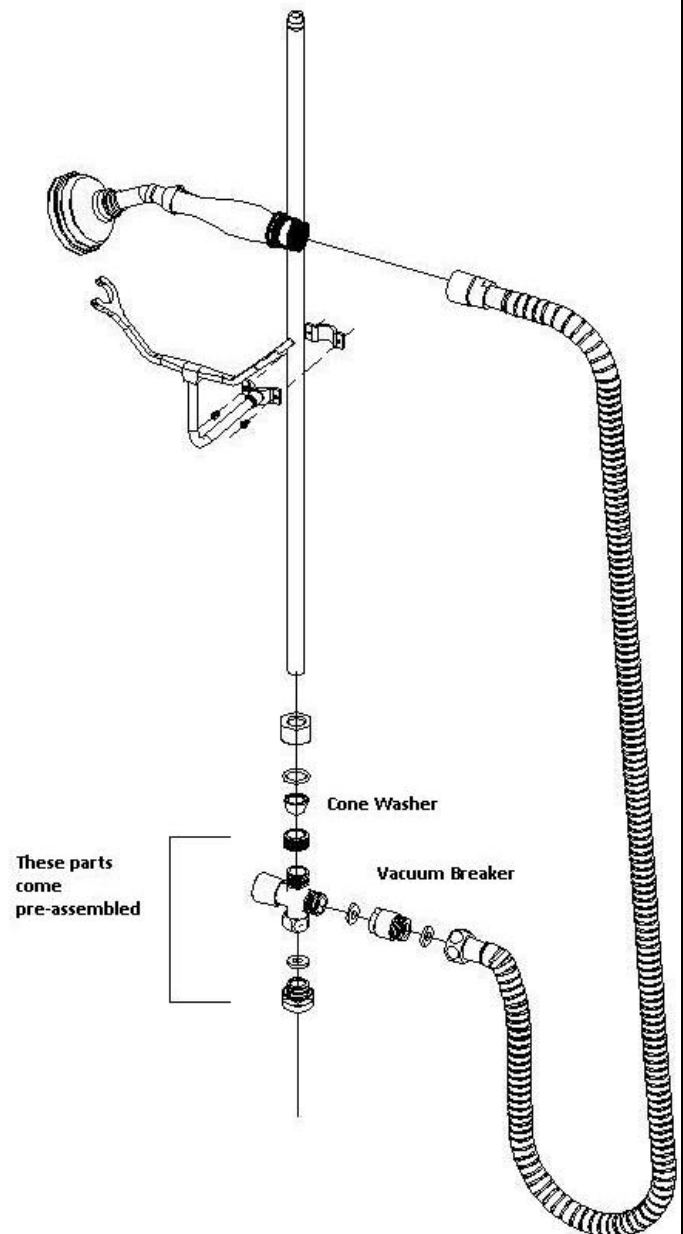

#### Parts Included:

- Diverter Kit
- Vacuum Breaker
- Handheld Shower & Hose
- Riser Handheld Bracket

(Riser is sold separately)