

Strom Plumbing



Ph: (916) 638-2722 / Fax: (916) 638-2725

Installation Information

Item #P0655

Wall Mount Faucet with 3 3/8" Centers

Warranted only when installed by a qualified, licensed plumber. Please use Teflon tape on all threaded connections.

Please use Teflon tape on all threaded connections.

1. Shut off the water supply to the fixture before installation.
2. Rough in 1/2" IPS male pipe, 1/2" past the finished wall, with 3 3/8" centers.

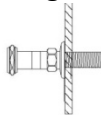

- 3.
4. Thread on the wall mount couplers. Insert the screen washer into the nut of the coupler.
5. Attach the faucet body to the wall mount couplers and tighten nuts to secure.
6. Attach the spout and tighten the hold down nut to hold in place.
7. Attach the handles with the screws provided.
8. Remove the aerator from the end of the spout and turn on the water supply to flush the hot and cold lines until the water is clear.
9. Make no adjustments to valves or valve stems. They are tested at the factory for optimum performance.

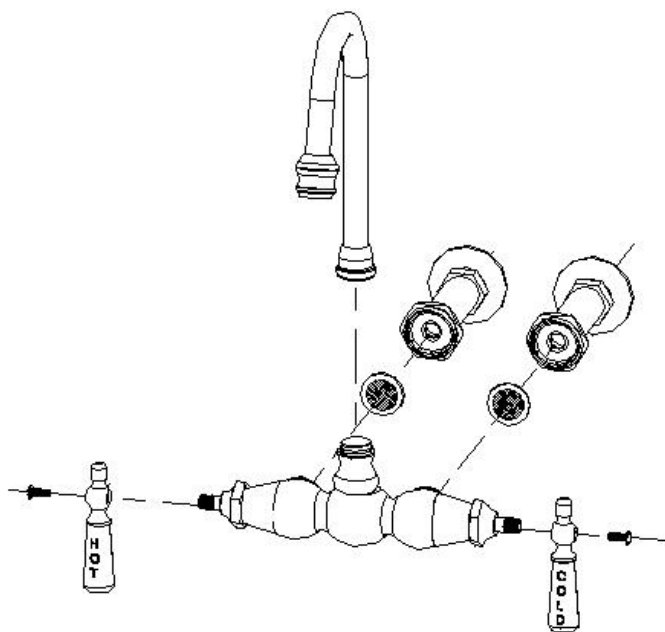

Parts Included:

- Faucet Body
- Gooseneck Spout
- Handles (2)
- Wall Mount Coupler, pair