

Installation Information

Item #P0894

Thermostatic Wall Mount Faucet with 7" Centers

Warranted only when installed by a qualified, licensed plumber. Please use Teflon tape on all threaded connections.

Please use Teflon tape on all threaded connections.

1. Shut off the water supply to the fixture before installation.
2. Rough in $\frac{1}{2}$ " IPS male pipe, $\frac{1}{2}$ " past the finished wall, with 7" centers.
Note: The bottom of the spout is approximately $4\frac{1}{2}$ " below the inlet rough-in and the extension from the wall to the front of the spout is approximately $10\frac{1}{2}$ ".

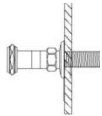

3. Thread on the wall mount couplers. Insert the screen washer into the nut of the coupler.
4. Attach the faucet body to the wall mount couplers and tighten nuts to secure.
5. Connect the cradle to the faucet using washers provided. Tighten the nut to secure in place.
6. Attach the nut end of the hose to the Inlet cradle and the tapered end of the hose to the hand shower. Place the hand shower on the cradle.
7. Make no adjustments to valves or valve stems. They are tested at the factory for optimum performance.

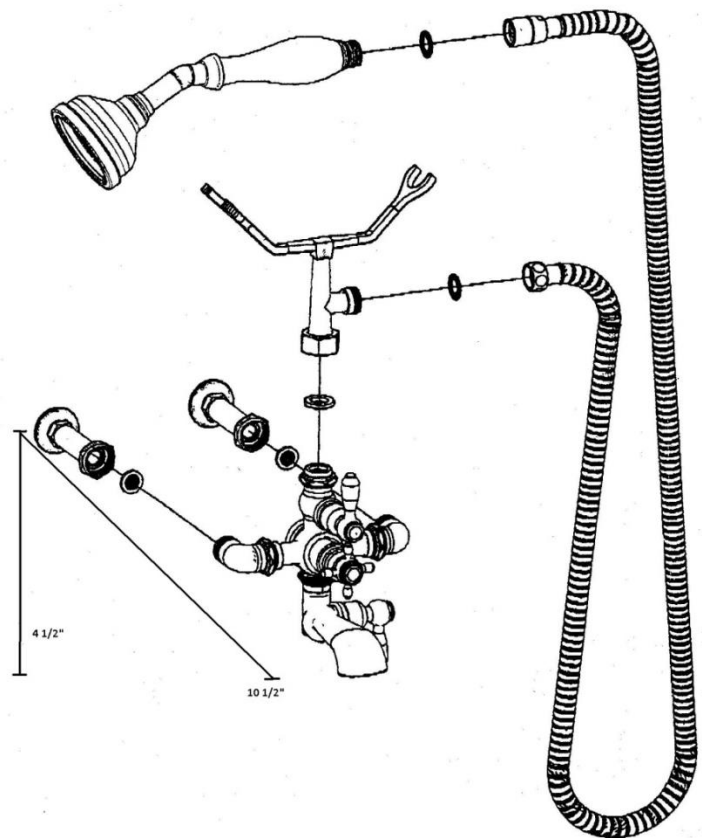

This faucet is tested to remain within 1 degree Fahrenheit of your desired setting throughout its operation, with an automatic temperature stop at 104 degrees Fahrenheit. The unit also has a built-in anti-syphon.