

# Strom Plumbing

BY  
Sign of  the Crab

Ph: (916) 638-2722 / Fax: (916) 638-2725

## Installation Information

### Tub Only Set

**Warranted only if installed by a qualified licensed plumber. Use Teflon tape on all threaded connections.**

1. The maximum wall thickness is 1 1/2".
2. Rough in the valves from the back of a finished wall, assuring there is a proper distance for escutcheons and handles on the valve stems.
3. The spread between the Hot and Cold valves is **8" on center** with supplied nipples connected to the supplied Tee.
4. Connect the Hot & Cold valves to 1/2" iron pipe size water supply, where the union and large nut are pointed down.

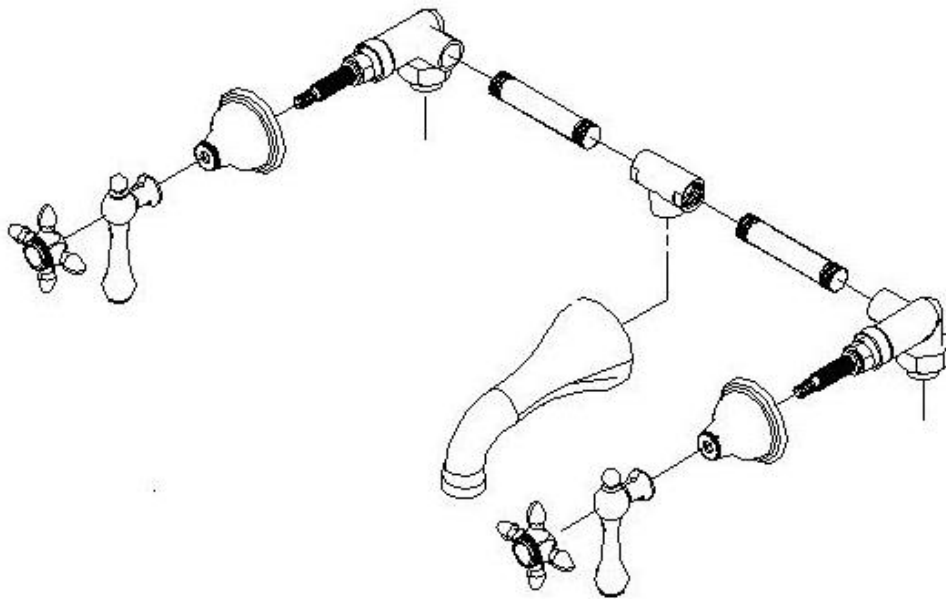

<b>Tub only Sets</b>	<b>Centers</b>	<b>Escutcheon Diameter</b>	<b>Escutcheon Height</b>	<b>Handle Length</b>
P0105	8"	2 1/4"	1 1/2"	3 1/2"
P0157	8"	2 7/8"	1 7/8"	3 1/4"
P0406	8"	2 3/4"	2"	3 1/4"
P0408	8"	2 7/8"	1 3/4"	3 1/4"
P0412	8"	2 1/2"	1 3/4"	3 1/4"
P0449	8"	2 7/8"	1 3/4"	3 1/2"
P0590	8"	2 1/2"	1 3/4"	3"
P0807	8"	2 7/8"	1 7/8"	2 1/16"
P0845	8"	2 1/4"	1 1/2"	3 1/4"